



GARDEN STATE LUMBER
PRODUCTS CORP.

GS
MILLWORK
PREMIUM WOOD PRODUCTS

VERTICAL TAMBOUR INSTALLATION GUIDE



*All hardwoods should be allowed ample time to acclimate to a climate controlled environment prior to installation.

TAMBOUR STEP

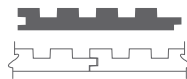

1 x 6
(3/4 x 5-1/2)
TGSTEP

TAMBOUR ROUND



1 x 6
(3/4 x 5-1/2)
TGROUND

TAMBOUR SCOOP



1 x 6
(3/4 x 5-1/2)
TGSCOOP

OPTION 1: USING FURRING STRIPS

STEP 1

LOCATE THE STUDS

Use a stud finder to find and mark the stud locations on the wall.

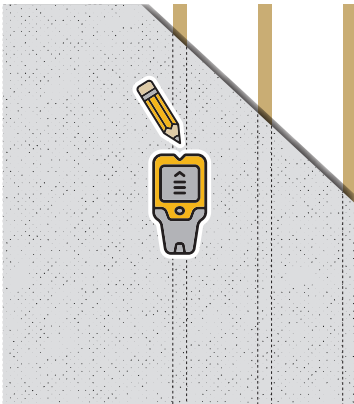

STEP 2

INSTALL THE FURRING STRIPS

Secure horizontal furring strips (1' x 3' or 1' x 4') across the studs, spaced 16"-24" apart.

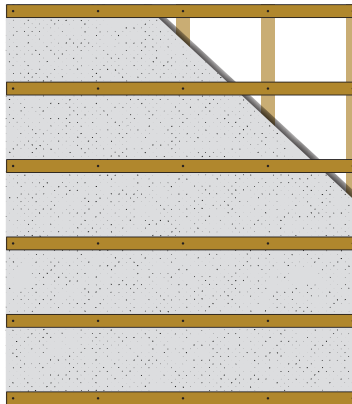

STEP 3

ATTACH THE TAMBOUR PLANKS

Mount the vertical tambour planks onto the furring strips with nails or adhesive.

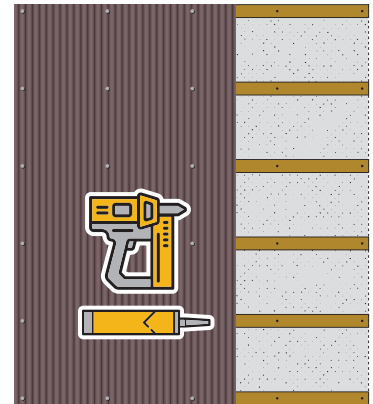

OPTION 2: USING PLYWOOD BACKING

STEP 1

LOCATE THE STUDS

Find and mark the studs as you would for the furring-strip method.

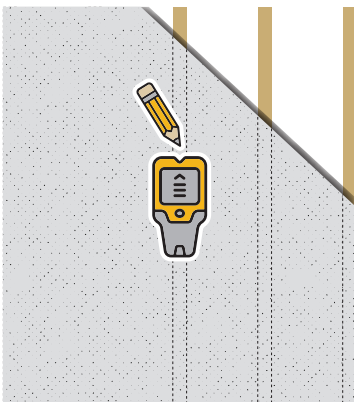

STEP 2

INSTALL THE PLYWOOD SHEETS

Use 1/2-inch plywood sheets and secure them to the studs to create a stable backing.

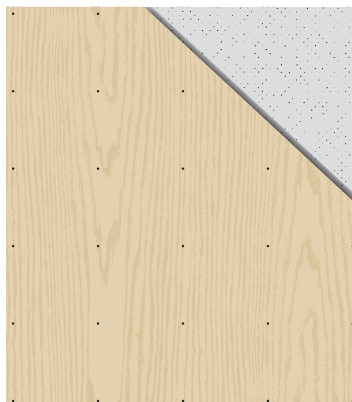

STEP 3

MOUNT THE TAMBOUR PLANKS

Attach the tambour planks vertically to the plywood sheets for a secure installation.

